

**Side-by-side comparison of traditional building methods vs EMAGISPACE®.**

Factors of labor, material and time are compared for the Assembly/Build, Strike, Reset and Storage of a "Study Set".

**COST ANALYSIS**

**CONSTRUCTING, STRIKING AND RESTING A "STUDY SET"**



EMAGIBLOCKS®

VS



TRADITIONAL

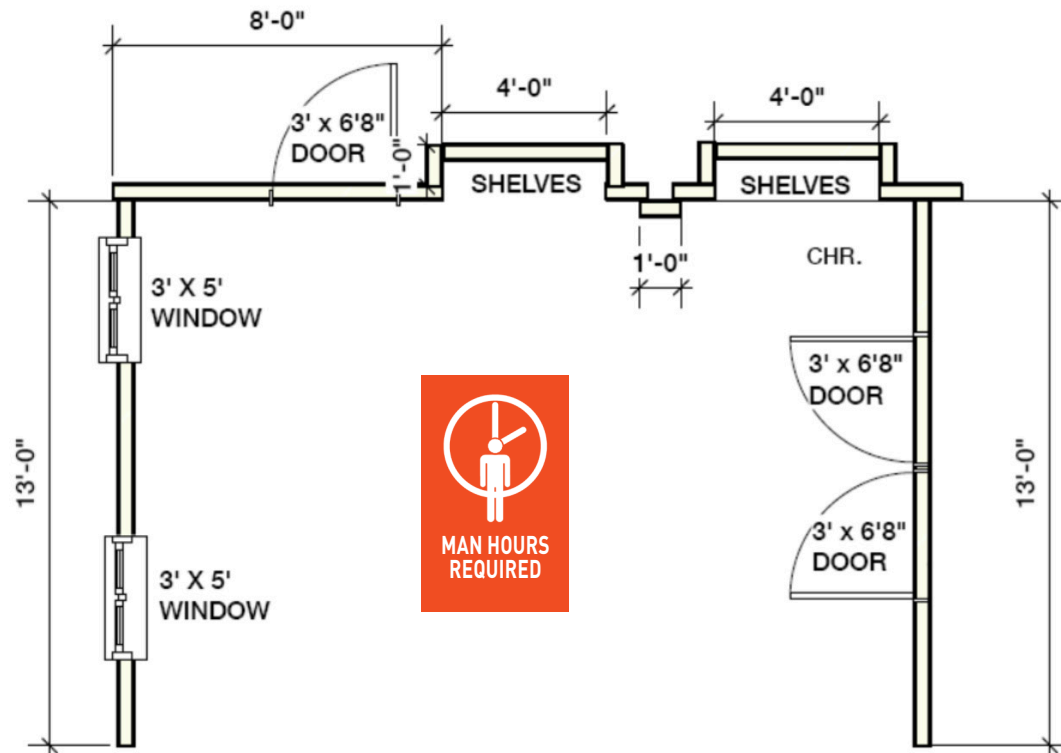



### Traditional Stick

#### ASSEMBLE/BUILD

Building Materials, Cover/Finish = \$6,500  
2 Windows, 3 Doors = \$1,800  
4 carpenters: 30hrs @ \$50/hr = \$6,000  
2 scenic painters: 30hrs @ \$45/hr = \$2,700  
Fringe (Payroll tax, Pension, etc.) @ 36% = \$3,618

**SUBTOTAL \$20,618**

#### STRIKE

Grip crew for strike: 10 workers/10hrs @ 40/hr = \$4,000  
Grips to load walls on truck: 4 workers/2hrs @ \$40/hr = \$320  
Warehouse crew to store walls: 4 workers/2hrs @ \$36/hr = \$288

#### RESET

Warehouse crew to pull walls: 4 workers/2hrs @ \$36/hr = \$288  
Grips to unload truck: 4 workers/1hr @ \$36/hr = \$144  
Grips crew for wall reset: 10 workers/4hrs @ \$40/hr = \$1,600  
Scenic artist for reset: 2 workers/8hrs @ \$45/hr = \$720  
Fringe (Payroll tax, Pension, etc.) @ 36% = \$2,650  
Contingency = \$4,600

#### STORAGE

Annual storage costs: 250sqft @ \$1.25 = \$3,750

**361**  
MAN HOURS

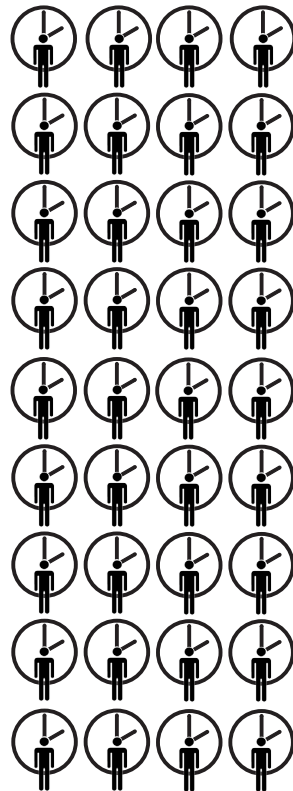

**TOTAL COST**

**\$38,978**

### EMAGISPACE®

#### ASSEMBLE/BUILD

Building Materials, Cover/Finish = \$8,400  
2 Windows, 3 Doors = \$1,800  
2 carpenters: 20hrs @ \$50/hr = \$2,000  
2 scenic painters: 30hrs @ \$45/hr = \$2,700  
Fringe (Payroll tax, Pension, etc.) @ 36% = \$1,692

**SUBTOTAL \$16,592**

#### STRIKE

Grip crew for strike: 5 workers/8hrs @ \$40/hr = \$1,600  
Grips to load walls on truck: 2 workers/1hr @ \$40/hr = \$80  
Warehouse crew to store walls: 2 workers/1hr @ \$36/hr = \$72

#### RESET

Warehouse crew to pull walls: 2 workers/1hr @ \$36/hr = \$72  
Grips to unload truck: 2 workers/1hr @ \$36/hr = \$72  
Grips crew for wall reset: 4 workers/2hrs @ \$40/hr = \$320  
Scenic artist for reset: 2 workers/8hrs @ \$45/hr = \$720  
Fringe (Payroll tax, Pension, etc.) @ 36% = \$1,057  
Contingency = \$2,300

#### STORAGE

Annual storage costs: 56sqft @ \$1.25 = \$840

**172**  
MAN HOURS

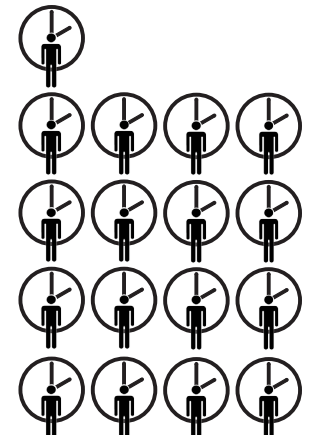

**TOTAL COST**

**\$23,725**