



EMAGISPACE™
Build smarter.

SPACE
RE-IMAGINE

RE-IMAGINE SPACE. BUILD SMARTER.

Emagispace® has developed a sustainable building block technology that makes it possible to re-imagine the construction of interior space. EmagiBlock® is the next-gen, versatile, reusable building technology that can be constructed – and infinitely reconfigured and re-purposed – **in a fraction of the time, effort and cost of traditional construction.** Easily build trade show booths, displays, performance sets, and elegant interior spaces of all sizes and configurations.



These interlocking building blocks are the cornerstone of our system. Available in standard (41" high x 1ft, 2ft, and 3ft wide) and designed-to-order sizes. Every EmagiBlock® is built to a standard 4.5" depth.

Build economically.

Build at a fraction of the cost of traditional methods.

Build faster.

Construct interior space up to 10 times faster.



Build green.

Made of environmentally friendly, recyclable materials.

Build on-demand.

Re-imagine space as your needs change or inspiration strikes.

EMAGISPACE® GIVES YOU THE BEST OF BOTH WORLDS.

STICK FRAME

**Cost-effective
& Familiar**



EMAGISPACE®

**Cost-effective, Familiar,
Sustainable & Flexible**



MODULAR SYSTEMS

**Sustainable
& Flexible**





CREATE SPACE WITH LESS LABOR. LESS COST. FASTER.

The patented, precision-built EmagiBlock® platform is comprised of lightweight ABS plastic interlocking blocks, faced on both sides with environmentally friendly, medium density fiberboard panels (MDF), and turnkey assembly components such as connectors, doors, windows, trim, and finishes, including our revolutionary EmagiPanel™ wall-cladding system. **And, because we are an open source platform you can even source your own finishes!** Emagispace® is just like traditional building materials only faster, more affordable and sustainable.

HOW DOES THE EMAGIBLOCK® SYSTEM WORK?



Assemble

Build your EmagiBlock® structure in minutes not hours



Skin & Finish

Apply a skin/finish over the EmagiBlock® structure using almost any material (i.e. vinyl panels, wood laminate, fabric, metal, drywall, etc.)



Reconfigure

Easily modify or expand when need or inspiration strikes. You can easily incorporate doors and windows, as well as electrical and plumbing

EmagiBlock®s just click together and are easily assembled within minutes.



Unique assembly components allow you to connect to existing structures or to Emagispace® components giving you the flexibility to bring your ideas to life.



**1/10
Time**



**Open
Source**



**1/2 the
Cost**



**Design
Innovation**



**Scales
Easily**



**Sustainable
& Reusable**

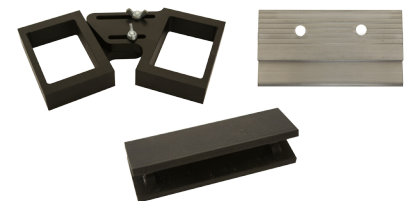

WE MAKE IT EASY TO BUILD WITH EMAGISPACE®.

Using your design information, we will provide you a comprehensive project design plan; specifying all the Emagispace® components needed to build your project. Our team of experts are available for input and insights throughout the entire building process.

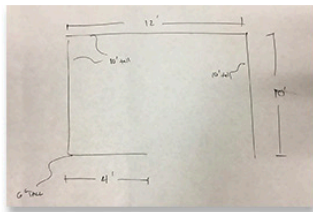

Design Information

From basic drawings to CAD renderings, our team is here to help bring your project to life.

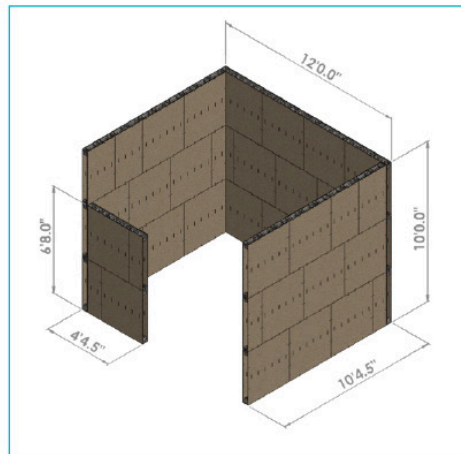

Project Design Plan

From your design information, we produce a project design plan that details all the Emagispace® components required to build your specific project.



Production

Our design and construction experts are available to consult with you about any product insights or issues throughout your building process.

STREAMLINE THE BUILDING PROCESS.

The interior building process can require multiple people and departments working together. Often times the need for modifications or changes pop-up, the process then becomes disconnected and finger pointing begins. The Emagispace® process can help you avoid these problems. EmagiBlock®, because of their inherent flexible design, can accommodate changes and modifications with minimal additional cost and time. Ultimately creating a better end product and a happier end-user.

Typical Building Process



Emagispace® Building Process

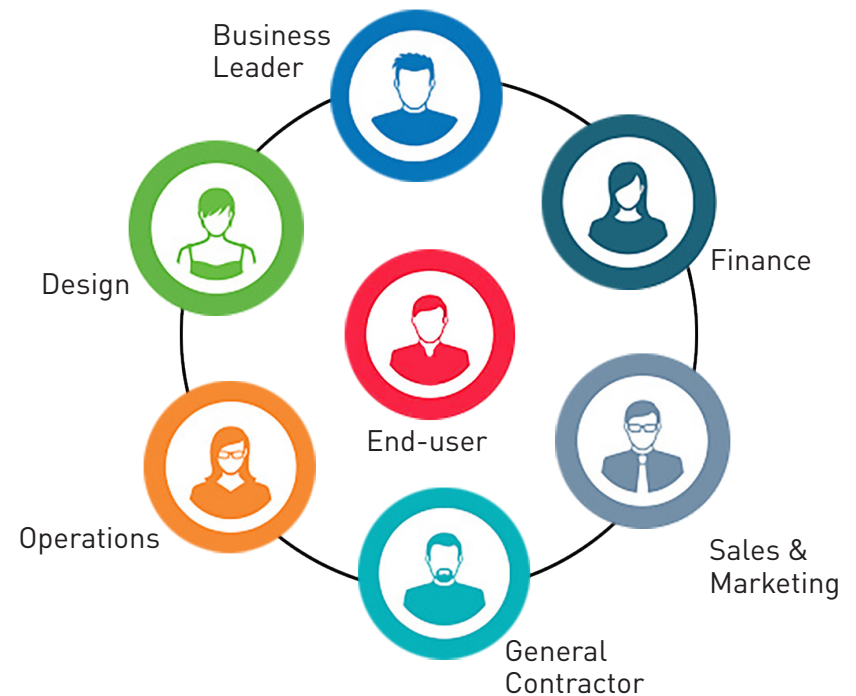

MEASURING UP IN THE LONG RUN.

The growth value of Emagispace® is significant when used across a spectrum of interior space applications. For example, you can start with quick and easy to assemble solutions, like pony walls and cubicles, then add more value by creating meeting spaces or large-scale build-outs.

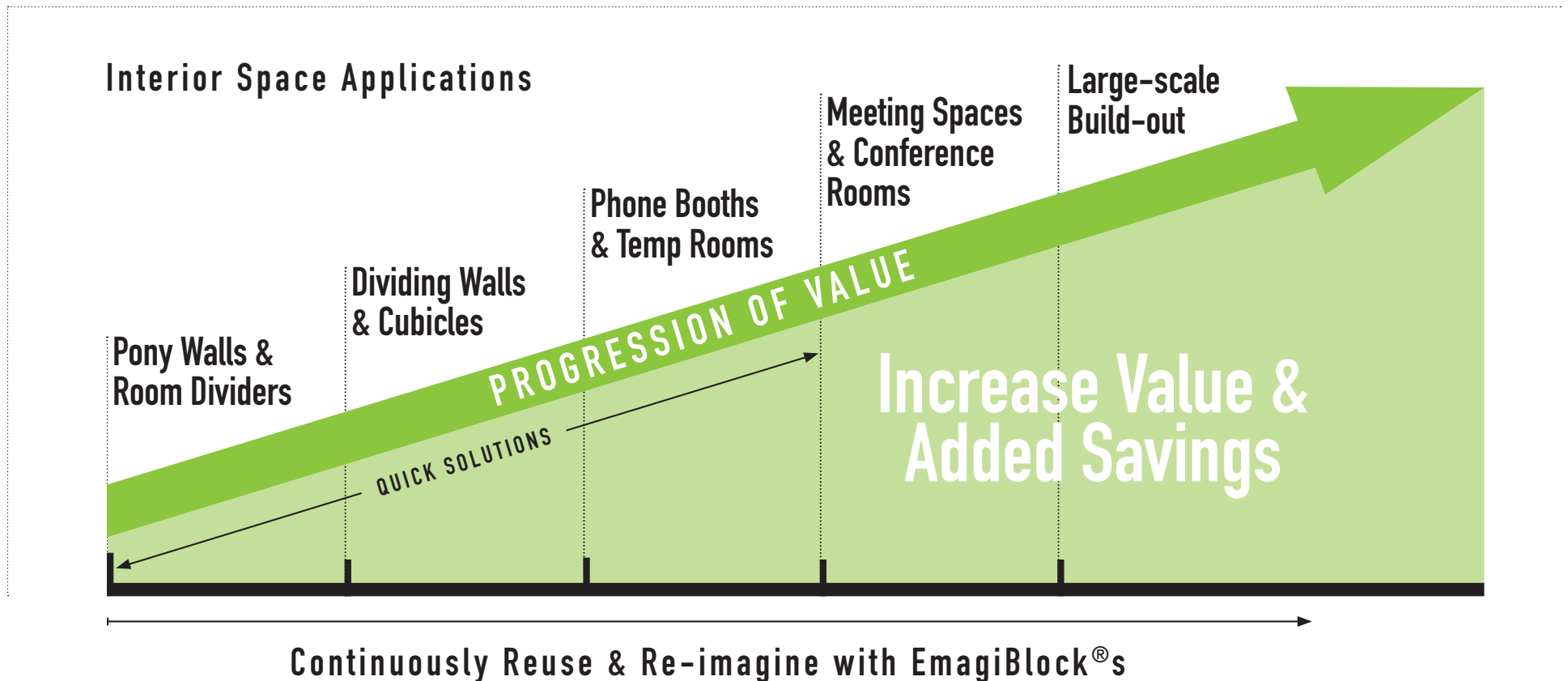



EMAGIBLOCKS®.

These interlocking building blocks are the cornerstone of our system.

- Available in standard (41" high x 1ft, 2ft, and 3ft wide) and designed-to-order sizes. Every EmagiBlock® is built to a standard 4.5" depth
- High-tech engineering provides stability and a smooth finish for creating solid, stunning structures, with 20 times the longevity of traditional methods
- Each EmagiBlock® features top and bottom reversible ConnectorBlocks made of tough, impact resistant ABS plastic
- Easily assembled, all you need is a cordless drill
- Supports hanging weights in excess of 150lbs and solutions for even heavier weights

**1ft-wide
EmagiBlock®**

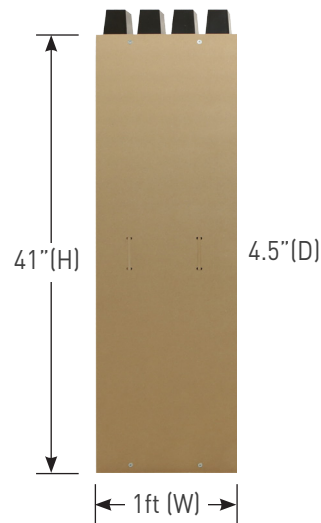

**2ft-wide
EmagiBlock®**



**3ft-wide
EmagiBlock®**

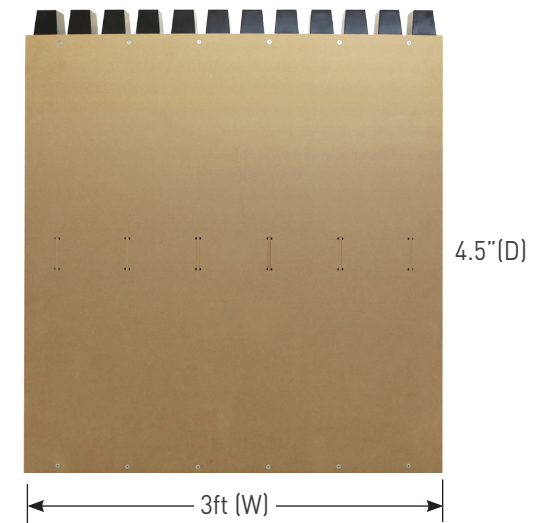

EMAGIBLOCK® INSIGHTS

Simply invert the ConnectorBlocks and create a flat and level surface to finish/cover EmagiBlock®s



ConnectorBlocks (made of impact-resistant ABS plastic) are on the top and bottom of each EmagiBlock®



Each EmagiBlock® is designed with horizontal and vertical channels that allow for easy placement of electrical and plumbing. The sides of an EmagiBlock® can be sealed off and acoustic material blown in.

SKINS & FINISHES.

Customize Emagiblock® with unlimited covers and finish options. Unleash your imagination!

- **Decide on the level of finish you looking for, then choose from a wide assortment of readily available materials, textures and patterns to cover & finish EmagiBlock®**
- **Our EmagiPanel™ wall-cladding system and MDF Decorative Panels can be shipped directly to you, ready for assembly.**



Example of a white cover being applied for an art gallery

Examples of Available Covers & Finishes

These are only a few examples of the many options available, please ask a customer service representative for assistance

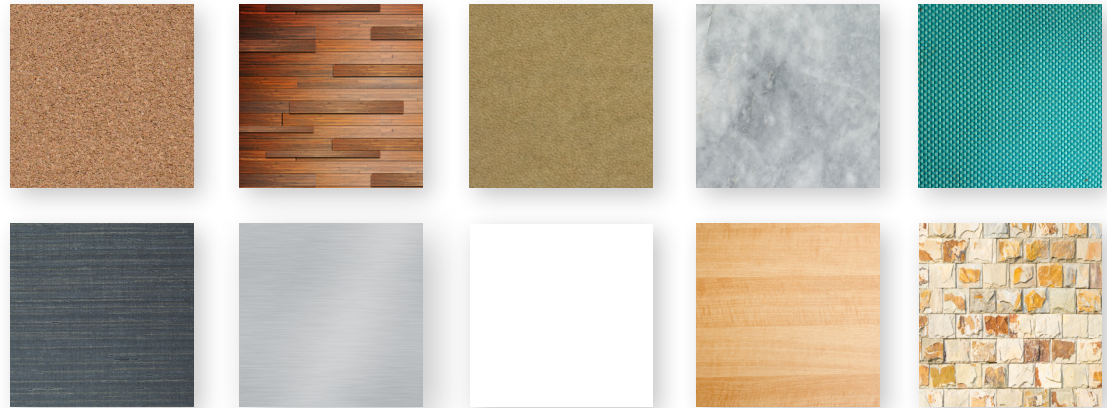

FINISH LEVELS

Smooth (like traditional smooth white wall finishes).

Patterned finishes can be troweled on like stucco and plaster.

Seemed finishes such as brick patterns, wallpapers, etc., are easily applied.

Seamless finishes work just as they do with any construction wood product. Traditional tape, putty, and paint processes are easily achieved.

New cutting edge 3D relief thermoplastics that are printable from deep relief to flatter patterns and come in a vast array of colors and finishes.

White to saturated, almost all of the above option allow for painting in any color.

ADDITIONAL WALL FINISH OPTIONS.



EmagiPanel™ WALL-CLADDING SYSTEM

A revolutionary finishing system, EmagiPanel™ quickly and easily installs up to 7 times faster than traditional finishes on desks or cabinets and drywall or plasterboard.

A virtually seamless finish with contemporary aesthetics, EmagiPanel™ is the perfect modular, adaptable, covering that allows for quick reconfiguring and redecorating.

MDF DECORATIVE PANELS

Emagispace® has assembled a vast array of inspiring solutions designed to meet your aesthetic and practical needs. We offer a wide array of finishes that mount to MDF panels which are then attached to EmagiBlock®s. From bare MDF, to colors, to focal point, to mood setting, we can provide anything from dry-erase and cork-board to engaging and provocative digital images in 3D relief, to acoustically damping flush mounted baffles.



ADDING WINDOWS AND DOORS.

Emagispace® prides itself on being an open source building platform, simply source your own window or door and you'll be able to mount it easily and quickly to our system. It's no problem to incorporate small, large, or entire walls of windows and doors, in almost any wall location.

INSTALLING WINDOWS



Option 1: Steel apertures with almost any window mounted inside can be framed or frameless and come in virtually any size. Transom windows, square paned windows... you name it... EmagiBlock®s simply mount around the window.

Option 2: Mount 2' or 3' square windows inside an EmagiBlock® for endlessly reconfigurable design.

INSTALLING DOORS



Steel apertures with almost any door mounted inside can be framed or frameless and come in virtually any size. ADA compliant double doors, single hinge doors, Dutch doors... you name it, EmagiBlock®s simply mount around the door.

ASSEMBLY COMPONENTS.

EmagiPlate

The best longterm solution, EmagiPlate seamlessly connects an EmagiBlock® wall to another EmagiBlock® or existing wall.



EmagiClip

Use it to span two or more EmagiBlock®s to make a single unit that can be easily moved.



EmagiSpan System

While EmagiBlock®s are plumb and true to within 100th of an inch, the world is not as exact. When you're installing, and you need to expand your structure to fit a ceiling or an adjacent wall that is under 1' away from EmagiBlock®, our EmagiSpan System elegantly solves the problem. Precisely engineered, strong, and yet easy to install and use, the EmagiSpan System fits perfectly with EmagiBlock® and allows you to extend a plate any desired distance from 0"-12". Then, simply affix/finish with your wall covering as you would normally when using a traditional stud.

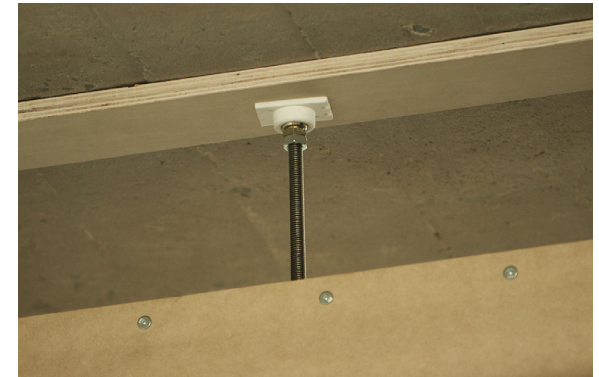

EmagiCleat

Great for temporary walls, EmagiCleat allows you to quickly connect to another EmagiBlock® or existing wall.



EmagiHinge

Create a locking mechanism that allows you to move the walls between 90-120 degrees while keeping the seam together. Great for display walls and sets.

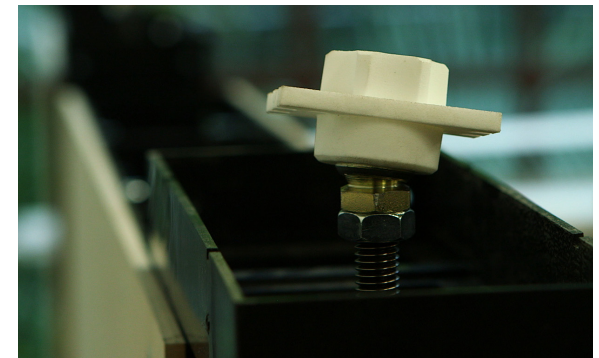
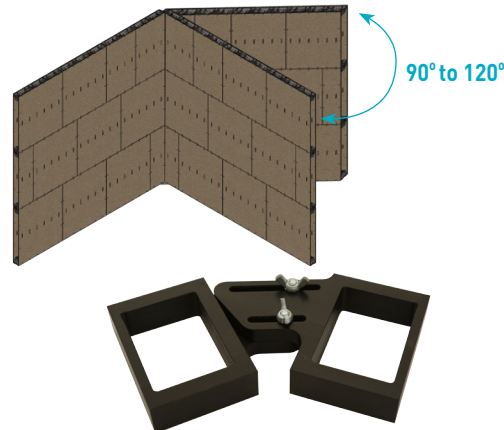

SMARTER BUILD

"Emagispace® allowed us to build 20 foot walls in half the time of traditional lumber-based sets, and then save the building blocks for future productions... So in essence, the walls went up in half the time and cut waste by about 50%. It was a win-win."

– Glenn Gainor
President, Physical Production at
Sony Pictures Screen Gems

EMAGISPACE® CLIENTS ARE BUILDING SMARTER



SONY



FARFETCH

HOW TO GET
AWAY WITH
MURDER



REVLON®



events LB design



SAVINGS, SUSTAINABILITY, DESIGN FLEXIBILITY.

Emagispace® enables “green” design innovation, speeds up build-out times, provides savings up to 50% on its first use and scales easily. Emagispace® is the next gen, disruptive building technology for a wide variety of interior space applications.



1/10
Time



Open
Source



1/2 the
Cost



Design
Innovation



Scales
Easily



Sustainable
& Reusable





WITH EMAGISPACE® YOU BUILD GREEN

Emagispace® offers a versatile, reusable building platform that can be constructed – and infinitely reconfigured and re-purposed. It is made from environmentally responsible materials. Unlike the landfill waste created by traditional construction methods, EmagiBlock® can be reused multiple times and is recyclable.



EMAGISPACE.
Build smarter.

PHONE 844-949-2557

EMAIL info@emagispace.com

WEB www.emagispace.com