



EMAGISPACE™
Build smarter.

SPACE
RE-IMAGINE
FACTORY

PERFORMANCE SETS BUILT SMARTER.



These interlocking building blocks are the cornerstone of our system. Available in standard (41" high x 1ft, 2ft, and 3ft wide) and designed-to-order sizes. Every EmagiBlock® is built to a standard 4.5" depth.

Film, Television and Theatre productions struggle to create a cost effective and more sustainable productions. With each new set that's built, an old one gets destroyed—trashed and discarded, adding tons to landfills. Isn't it time to re-imagine space? To build smarter? Emagispace® allows you to design and build the set you want, with less labor, at less cost—AND it's made of reusable, environmentally friendly materials.

Emagispace® utilizes a patented, kit-based interlocking building system to build high quality, solid walls. MDF facings create a base for literally any skin design.

Build economically.

Build at a fraction of the cost of traditional methods.

Build faster.

Construct interior space up to 10 times faster.



Build green.

Made of environmentally friendly, recyclable materials.

Build on-demand.

Re-imagine space as your needs change or inspiration strikes.



SCREEN GEMS

a Sony Company

SONY

"Emagispace® allowed us to build 20 foot walls in half the time of traditional lumber-based sets, and then save the building blocks for future productions... So in essence, the walls went up in half the time and cut waste by about 50%. It was a win-win."

– Glenn Gainor
President, Physical Production at
Sony Pictures Screen Gems





AMAZING SPACE

CREATE



CREATE SETS WITH LESS LABOR. LESS COST. FASTER.

This flexible system easily accommodates any door or window in any position. EmagiHinge allow walls to freely move for camera placements. Additional kits give you the flexibility to create entire rooms. Sets can now be created at half the cost and in one-tenth the time of a traditional build process. **That's 50% of the cost in one tenth the time!**

Additionally, Emagispace®'s simple and sturdy EmagiBlock® can be quickly disassembled, stacked or palletized to reuse again and again for other performance sets. So, your cost savings accumulate over time with the added benefit of landfill waste going down. It's the next gen, disruptive building technology for the Film, Television, and Theater industry.

EMAGISPACE® GIVES YOU THE BEST OF BOTH WORLDS.

STICK FRAME

Cost-effective
& Familiar



EMAGISPACE®

Cost-effective, Familiar,
Sustainable & Flexible



MODULAR SYSTEMS

Sustainable
& Flexible



The Emagispace® platform is made from environmentally responsible materials. Unlike the landfill waste created by traditional construction methods, EmagiBlock®s can be reused multiple times and is recyclable.



With EmagiBlock®s you can assemble a wall in 1/10th the time of traditional construction.



BUILDING BECOMES QUICK & EASY.

HOW DOES THE EMAGIBLOCK® SYSTEM WORK?



ASSEMBLE

Build your EmagiBlock® structure in minutes not hours.



SKIN & FINISH

Apply a skin/finish over the EmagiBlock® using almost any material (vinyl panels, EmagiPanel™ wall-cladding, wood laminate, metal, drywall, etc.).



RECONFIGURE

Easily modify or expand when need or inspiration strikes. You can easily incorporate doors and windows, as well as electrical and plumbing.

Our easy to assembly components bring your ideas to life with little effort.

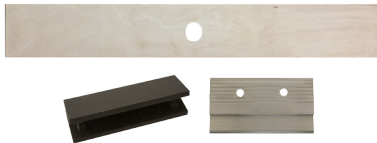

ConnectorBlocks (made of impact-resistant ABS plastic) are on the top and bottom of each EmagiBlock®.



Each EmagiBlock® is designed with horizontal and vertical channels that allow for easy placement of electrical and plumbing.

EmagiHinge allow walls to freely move between 90-120 degrees for ideal camera placements.

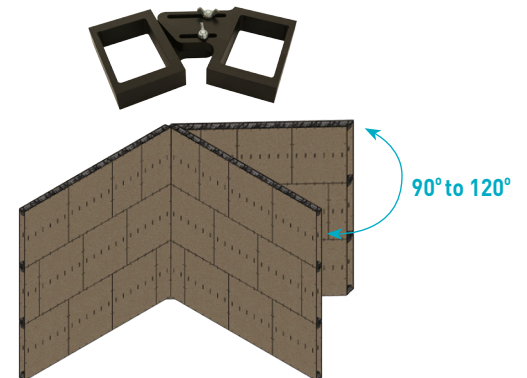



COLORADO
COLLEGE

MOTEL

"The bottom-line is that it takes a lot less people and a lot less time to build our sets using EmagiBlock®s."

"It's been really easy to mix EmagiBlock®s with our traditional building materials."

"There's no need for additional skills or tools."

- Paul Martin,
Technical Director of the Theater & Dance



DESIGN FLEXIBILITY IS BUILT IN.

Unleash your imagination! EmagiBlock®s can be skinned and finished with almost any material and integrated with a wide variety of windows, doors. Since we are an open source building platform, you have the option to purchase your own skins and finishes. You can use Emagispace® modular finishes, such as our revolutionary EmagiPanel™ wall-cladding system, which come in a wide variety of colors and textures. We want to make it as easy as possible to build your vision.

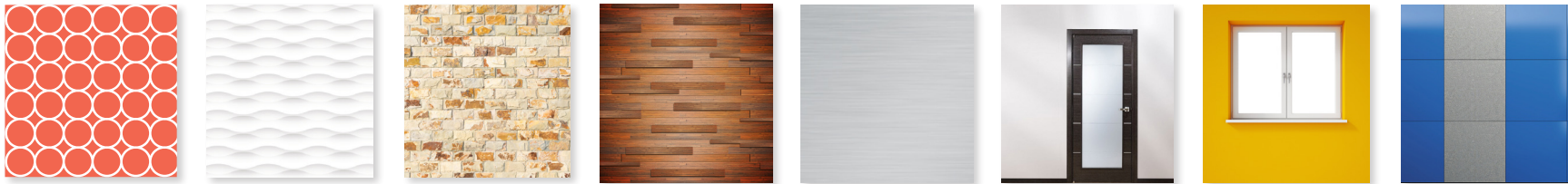

Endless options for skins and finishes

There is practically no end to the number of ways to skin and finish an EmagiBlock® wall. We make it easy for you to incorporate wall coverings like vinyl panels, EmagiPanel™ wall-cladding, wood laminate, metal, glass and drywall.

FINISH LEVELS.

Smooth (like traditional smooth white wall finishes).

Patterned finishes can be troweled on like stucco and plaster.

Seemed finishes such as brick patterns, wallpapers, etc. are easily applied.

Seamless finishes work just as they do with any construction wood product. Traditional tape, putty, and paint processes are easily achieved.

New cutting edge 3D relief thermoplastics that are printable from deep relief to flat patterns and come in a vast array of colors and finishes.

White to saturated, almost all of the above options allow for painting in any color.



EmagiPanel™ wall-cladding system

A revolutionary finishing system, EmagiPanel™ quickly and easily installs up to 7 times faster than traditional finishes on desks or cabinets and drywall or plasterboard. A virtually seamless finish with contemporary aesthetics, EmagiPanel™ is the perfect modular, adaptable, covering that allows for quick reconfiguring and redecorating.

MDF decorative panels

Emagispace® has assembled a vast array of inspiring solutions designed to meet your aesthetic and practical needs. We offer a wide array of finishes that mount to MDF panels which are then attached to EmagiBlock®s. From bare MDF, to colors, to focal point, to mood setting, we can provide anything from dry-erase and cork-board to engaging and provocative digital images in 3D relief, to acoustically damping flush mounted baffles.



ADDING WINDOWS AND DOORS.

Emagispace® prides itself on being an open source building platform, simply source your own window or door and you'll be able to mount it easily and quickly to our system. It's no problem to incorporate small, large, or entire walls of windows and doors, in almost any wall location.

INSTALLING WINDOWS



Option 1: Steel apertures with almost any window mounted inside can be framed or frameless and come in virtually any size. Transom windows, square paned windows... you name it... EmagiBlock®s simply mount around the window.

Option 2: Mount 2' or 3' square windows inside an EmagiBlock® for endlessly reconfigurable design.

INSTALLING DOORS



Steel apertures with almost any door mounted inside can be framed or frameless and come in virtually any size. ADA compliant double doors, single hinge doors, Dutch doors... you name it, EmagiBlock®s simply mount around the door.



WE MAKE IT EASY TO BUILD WITH EMAGISPACE®.

Using your design information, we will provide you a comprehensive project design plan; specifying all the Emagispace® components needed to build your project. Our team of experts are available for input and insights throughout the entire building process.

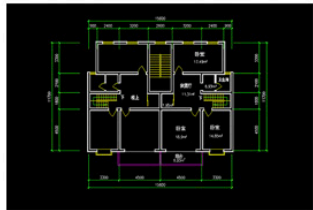
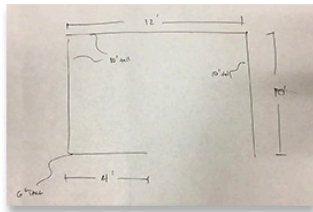

Design Information

From basic drawings to CAD renderings, our team is here to help bring your project to life.

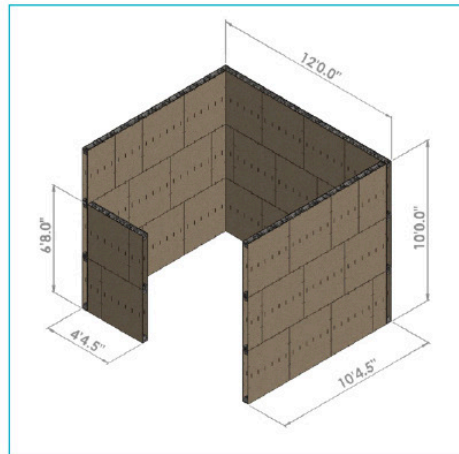

Project Design Plan

From your design information, we produce a project design plan that details all the Emagispace® components required to build your specific project.



Production

Our design and construction experts are available to consult with you about any product insights or issues throughout your building process.

STREAMLINE THE BUILDING PROCESS.

The set construction process can require multiple people and departments working together. Often times the need for modifications or changes pop-up, the process then becomes disconnected and finger pointing begins. The Emagispace® process can help you avoid these problems. EmagiBlock®s, because of their inherent flexible design, can accommodate changes and modifications with minimal additional cost and time. Ultimately creating a better end product and a happier end-user.

Typical Building Process



Emagispace® Building Process

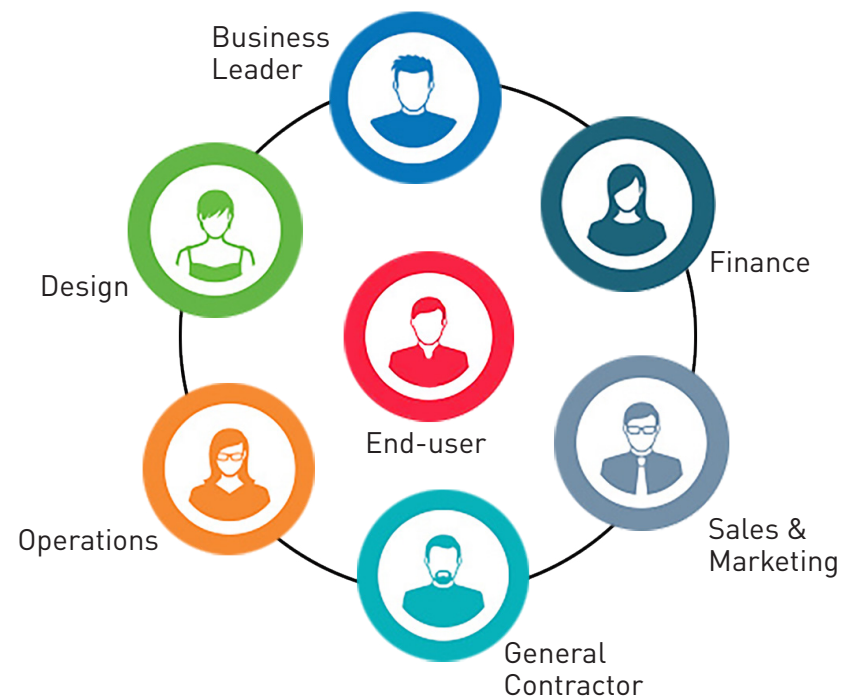

MEASURING UP IN THE LONG RUN.

The growth value of Emagispace® is significant when used across a spectrum of TV, movie and theater applications. For example, you can start with easy to assemble, quick solutions like limbo walls, then add more value by creating dressing rooms or a pop-up offices.

TV, Movie & Theatre Applications

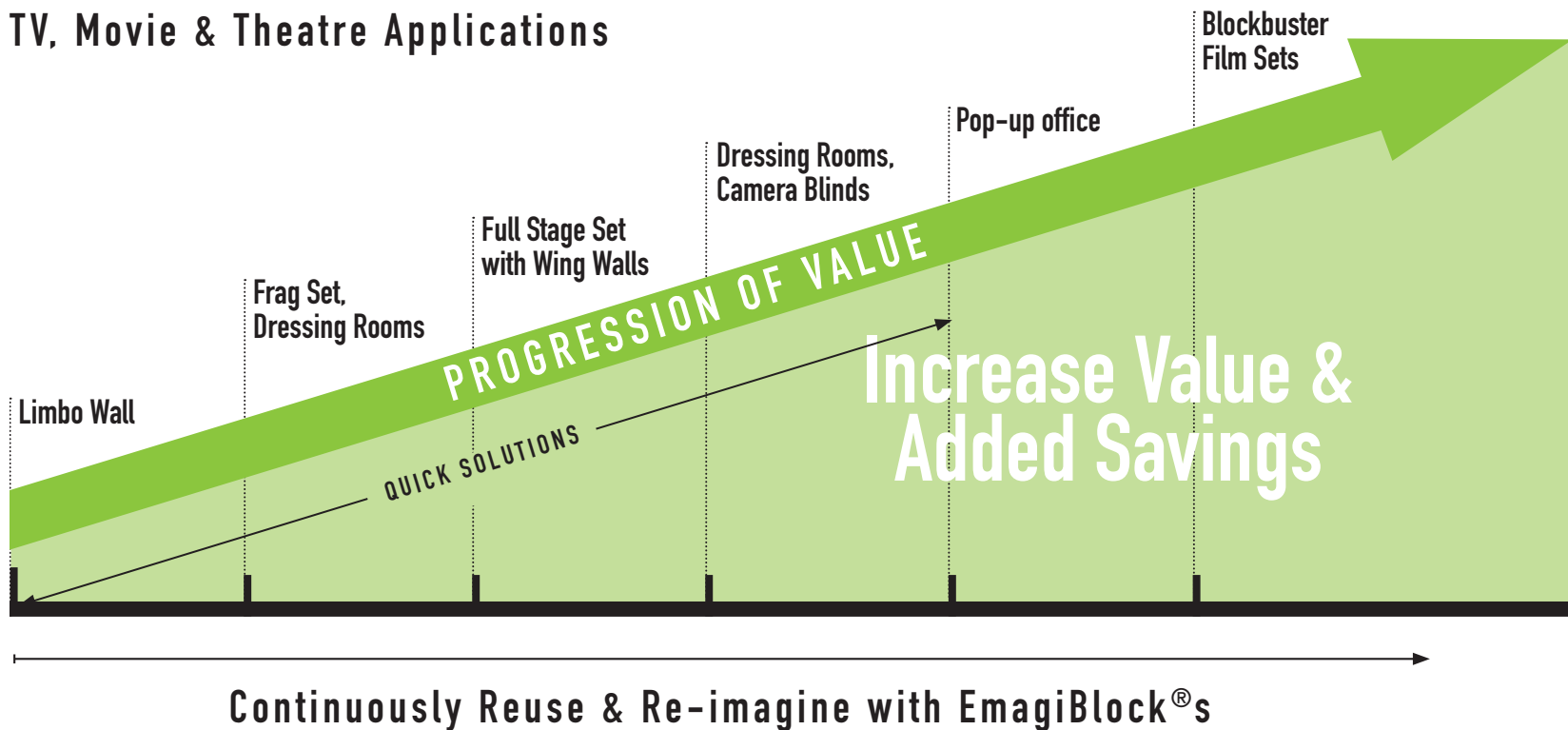



"Emagispace® allowed us to build 20 foot walls in half the time of traditional lumber-based sets, and then save the building blocks for future productions... So in essence, the walls went up in half the time and cut waste by about 50%. It was a win-win."

– Glenn Gainor
President, Physical Production at
Sony Pictures Screen Gems

EMAGISPACE® CLIENTS ARE BUILDING SMARTER



SONY



FARFETCH

**HOW TO GET
AWAY WITH
MURDER**



REVLON®



events **LB design**



SAVINGS, SUSTAINABILITY, DESIGN FLEXIBILITY.

Emagispace® enables “green” design innovation, adapts and scales easily, speeds up build-out times and provides savings up to 50% on its first use. Emagispace® is the next gen, disruptive building technology for Film, Television and Theatre productions.



**1/10
Time**



**Open
Source**



**1/2 the
Cost**



**Design
Innovation**



**Scales
Easily**



**Sustainable
& Reusable**



EMAGISPACE.
Build smarter.

PHONE 844-949-2557

EMAIL info@emagispace.com

WEB www.emagispace.com