



EMAGISPACE™
Build smarter.

SPACE
RE-IMAGINE

TRADE SHOW & CONVENTION SPACE BUILT SMARTER.



These interlocking building blocks are the cornerstone of our system. Available in standard (41" high x 1ft, 2ft, and 3ft wide) and designed-to-order sizes. Every EmagiBlock® is built to a standard 4.5" depth.

The challenge for trade show booths today is to create a well-designed “eye popping” space that attracts attention, is simple to ship and assemble, and so cost effective that it increases the number of shows your business can attend. It has to be reconfigurable too. So, new ideas to keep designs fresh can make a huge difference and increase sales. It’s now possible to design AND refresh your booth with better options... making it more affordable to re-imagine your trade show space... to build smarter.

EMAGISPACE® allows you to design and build any type or size of booth you want, in any color or design pattern you can imagine, with less labor, and less cost —AND it’s made of reusable, environmentally friendly materials. It’s modular, so you can easily adapt to show to show changes trade in booth regulations and height requirements.

Build economically.

Build at a fraction of the cost of traditional methods.

Build easier.

One person can build a booth in minutes.

Build green.

Made of environmentally friendly, recyclable materials.

Build on-demand.

Adapt and re-imagine space as your needs change or inspiration strikes.





The King
OF MEN'S GROOMING™

AMERICAN
CREW
Official Supplier to Men®

REVLON®

"Emagispace® made our design affordable, we were able to provide exactly what the client needs with efficient and easy packing and shipping."



AMAZING SPACE



CREATE SPACE WITH LESS LABOR. LESS COST. FASTER.

Emagispace® utilizes a patented, kit-based, interlocking building system to create high quality solid walls, displays, back lit shelving and light boxes. Additional kits give you the flexibility to create a private meeting area or refresh your look within the same show – not next season! MDF facings create a base for literally any skin design you desire.

Building private areas or an entire booth can now be completed at half the cost and in one-tenth the set up time of a traditional build process. **That's 50% of the Cost in One Tenth the Time!** With our EmagiBooth kit, one person can build a booth in minutes. Additionally, our simple and sturdy EmagiBlock® can be quickly disassembled, stacked or palletized to reuse again and again. So, your cost savings accumulate over time with the added benefit of landfill waste going down. It's the next gen, disruptive building technology for corporate events, trade shows and conventions.



The Emagispace® platform is made from environmentally responsible materials. Unlike the landfill waste created by traditional construction methods, EmagiBlock®s can be reused multiple times and is recyclable.



EMAGISPACE® GIVES YOU THE BEST OF BOTH WORLDS.

STICK FRAME

Cost-effective
& Familiar



EMAGISPACE®

Cost-effective, Familiar,
Sustainable & Flexible



MODULAR SYSTEMS

Sustainable
& Flexible



One person can quickly and easily build a booth in minutes with our EmagiBooth kit.



BUILDING BECOMES QUICK & EASY.

HOW DOES THE EMAGIBLOCK® SYSTEM WORK?



ASSEMBLE

Build your EmagiBlock® structure in minutes not hours.



SKIN & FINISH

Apply a skin/finish over the EmagiBlock® using almost any material (vinyl panels, EmagiPanel™ wall-cladding, wood laminate, metal, drywall, etc.).



RECONFIGURE

Easily modify or expand when need or inspiration strikes. You can easily incorporate doors and windows, as well as electrical and plumbing.

Our easy to assembly components bring your ideas to life with little effort.

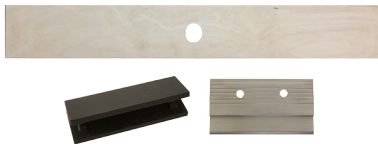

ConnectorBlocks (made of impact-resistant ABS plastic) are on the top and bottom of each EmagiBlock®.



Each EmagiBlock® is designed with horizontal and vertical channels that allow for easy placement of electrical and plumbing.

EmagiHinge allow walls to freely move between 90-120 degrees for ideal camera placements.

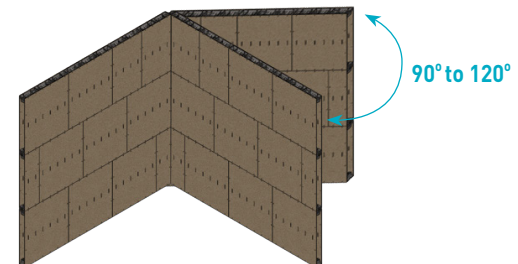

DESIGN FLEXIBILITY IS BUILT IN.

Unleash your imagination! EmagiBlock®s can be skinned and finished with almost any material and integrated with a wide variety of windows, doors. Since we are an open source building platform, you have the option to purchase your own skins and finishes. You can use Emagispace® modular finishes, such as our revolutionary EmagiPanel™ wall-cladding system, which come in a wide variety of colors and textures. We want to make it as easy as possible to build your vision.

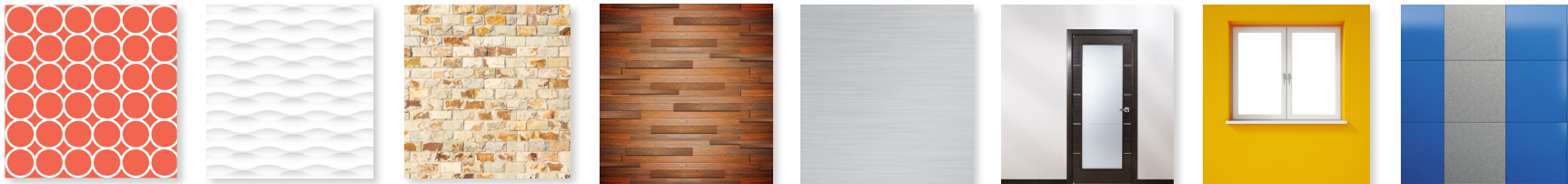

Endless options for skins and finishes

There is practically no end to the number of ways to skin and finish an EmagiBlock® wall. We make it easy for you to incorporate wall coverings like vinyl panels, EmagiPanel™ wall-cladding, wood laminate, metal, glass and drywall.

FINISH LEVELS.

Smooth (like traditional smooth white wall finishes).

Patterned finishes can be troweled on like stucco and plaster.

Seemed finishes such as brick patterns, wallpapers, etc. are easily applied.

Seamless finishes work just as they do with any construction wood product. Traditional tape, putty, and paint processes are easily achieved.

New cutting edge 3D relief thermoplastics that are printable from deep relief to flat patterns and come in a vast array of colors and finishes.

White to saturated, almost all of the above options allow for painting in any color.



EmagiPanel™ wall-cladding system

A revolutionary finishing system, EmagiPanel™ quickly and easily installs up to 7 times faster than traditional finishes on desks or cabinets and drywall or plasterboard. A virtually seamless finish with contemporary aesthetics, EmagiPanel™ is the perfect modular, adaptable, covering that allows for quick reconfiguring and redecorating.

MDF decorative panels

Emagispace® has assembled a vast array of inspiring solutions designed to meet your aesthetic and practical needs. We offer a wide array of finishes that mount to MDF panels which are then attached to EmagiBlock®s. From bare MDF, to colors, to focal point, to mood setting, we can provide anything from dry-erase and cork-board to engaging and provocative digital images in 3D relief, to acoustically damping flush mounted baffles.



ADDING WINDOWS AND DOORS.

Emagispace® prides itself on being an open source building platform, simply source your own window or door and you'll be able to mount it easily and quickly to our system. It's no problem to incorporate small, large, or entire walls of windows and doors, in almost any wall location.

INSTALLING WINDOWS



Option 1: Steel apertures with almost any window mounted inside can be framed or frameless and come in virtually any size. Transom windows, square paned windows... you name it... EmagiBlock®s simply mount around the window.

Option 2: Mount 2' or 3' square windows inside an EmagiBlock® for endlessly reconfigurable design.

INSTALLING DOORS



Steel apertures with almost any door mounted inside can be framed or frameless and come in virtually any size. ADA compliant double doors, single hinge doors, Dutch doors... you name it, EmagiBlock®s simply mount around the door.

WE MAKE IT EASY TO BUILD WITH EMAGISPACE®.

Using your design information, we will provide you a comprehensive project design plan; specifying all the Emagispace® components needed to build your project. Our team of experts are available for input and insights throughout the entire building process.

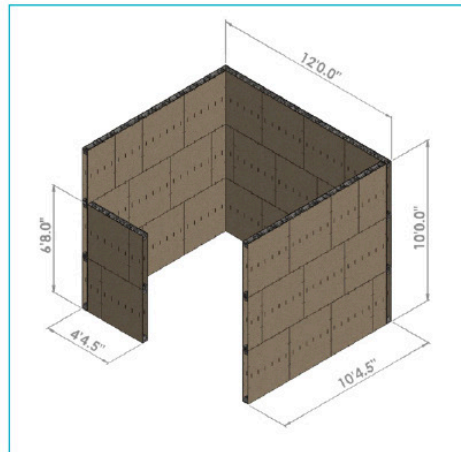
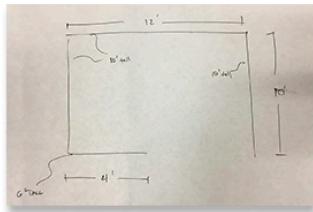

Design Information

From basic drawings to CAD renderings, our team is here to help bring your project to life.

Project Design Plan

From your design information, we produce a project design plan that details all the Emagispace® components required to build your specific project.

Production

Our design and construction experts are available to consult with you about any product insights or issues throughout your building process.



STREAMLINE THE BUILDING PROCESS.

The trade show booth building process can require multiple people and departments working together. Often times the need for modifications or changes pop-up, the process then becomes disconnected and finger pointing begins. The Emagispace® process can help you avoid these problems. EmagiBlock®, because of their inherent flexible design, can accommodate changes and modifications with minimal additional cost and time. Ultimately creating a better end product and a happier end-user.

Typical Building Process



Emagispace® Building Process



MEASURING UP IN THE LONG RUN.

The growth value of Emagispace® is significant when used across a spectrum of corporate event, trade show and convention applications. For example, you can start with quick and easy to assemble solutions like pop-up display kits, then add more value by creating meeting rooms or large-scale convention build-outs.

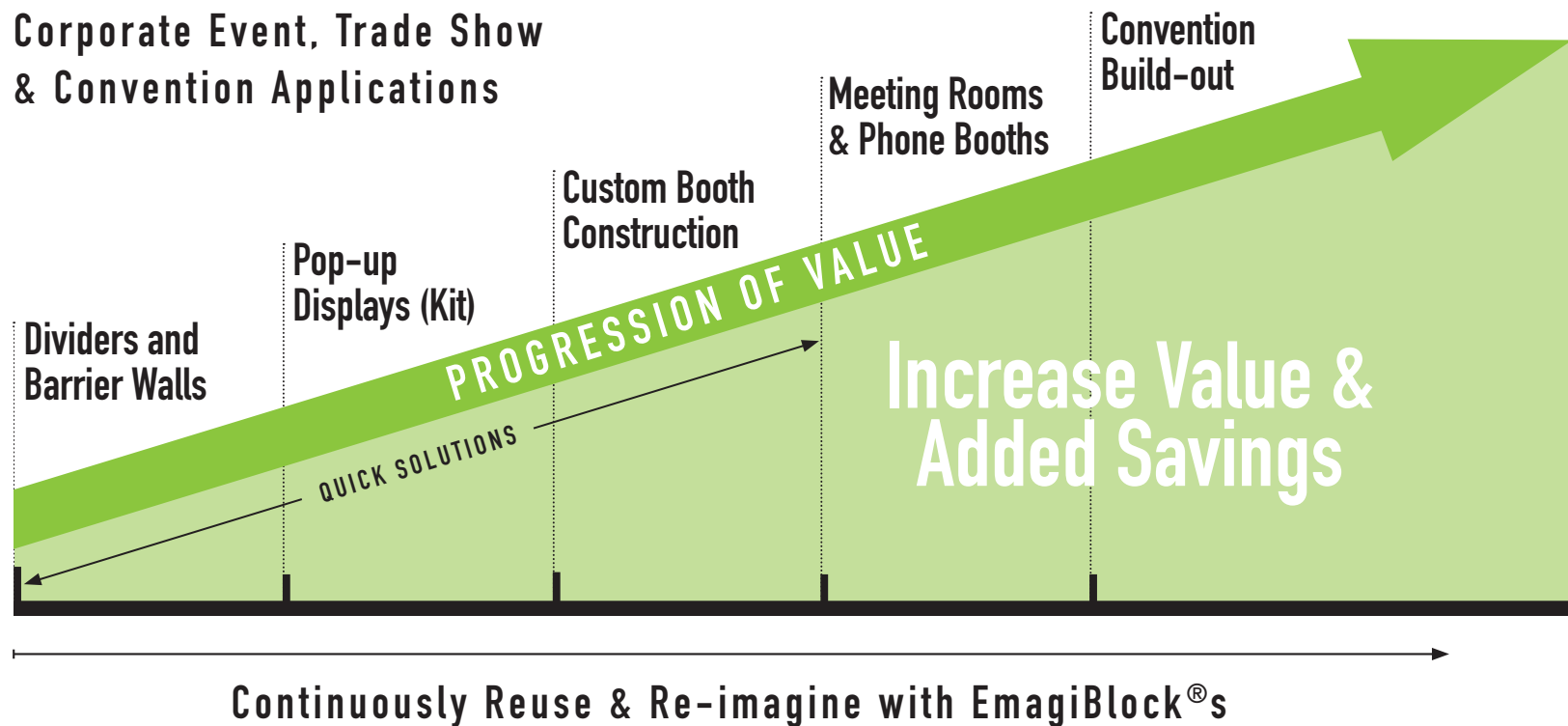



"Ultimately, we got a booth that truly made our products stand out in a crowded show environment, and cost us less than half of what we've spent on previous shows for a custom booth."

– Patrick Glynn
Western Regional Manager
MDC wall coverings, Inc.

EMAGISPACE® CLIENTS ARE BUILDING SMARTER



SONY



FARFETCH

HOW TO GET AWAY WITH MURDER



REVLON®



events **LB design**



SAVINGS, SUSTAINABILITY, DESIGN FLEXIBILITY.

Emagispace® enables “green” design innovation, speeds up build-out times, provides savings up to 50% on its first use and scales easily. Emagispace® is the next gen, disruptive building technology for a wide variety of interior space applications.



1/10
Time



Open
Source



1/2 the
Cost



Design
Innovation



Scales
Easily



Sustainable
& Reusable

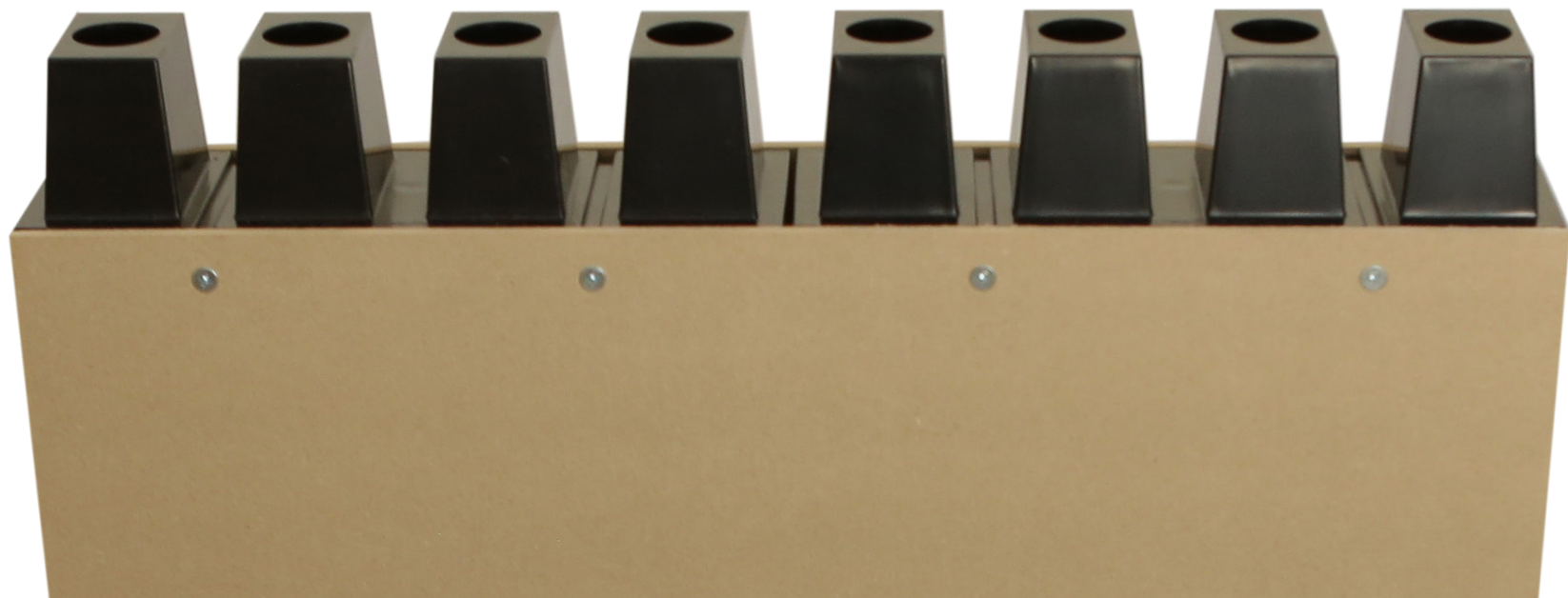



WITH EMAGISPACE® YOU BUILD GREEN

Emagispace® offers a versatile, reusable building platform that can be constructed – and infinitely reconfigured and re-purposed. It is made from environmentally responsible materials. Unlike the landfill waste created by traditional construction methods, EmagiBlock® can be reused multiple times and is recyclable.



EMAGISPACE

Build smarter.

PHONE 844-949-2557

EMAIL info@emagispace.com

WEB www.emagispace.com